

FOR SALE

MAJOR PRICE REDUCTION



*Corner of Oxford Rd
(RTE 67) & Hogs Back Rd
Oxford, CT 06478*

26 Acres

**Oxford Professional District Zoned Land
High traffic corner location on RTE 67**

Traffic Count 12,000 Cars

Daily per DOT

Many Development Options

Low Price of: \$239,000.00



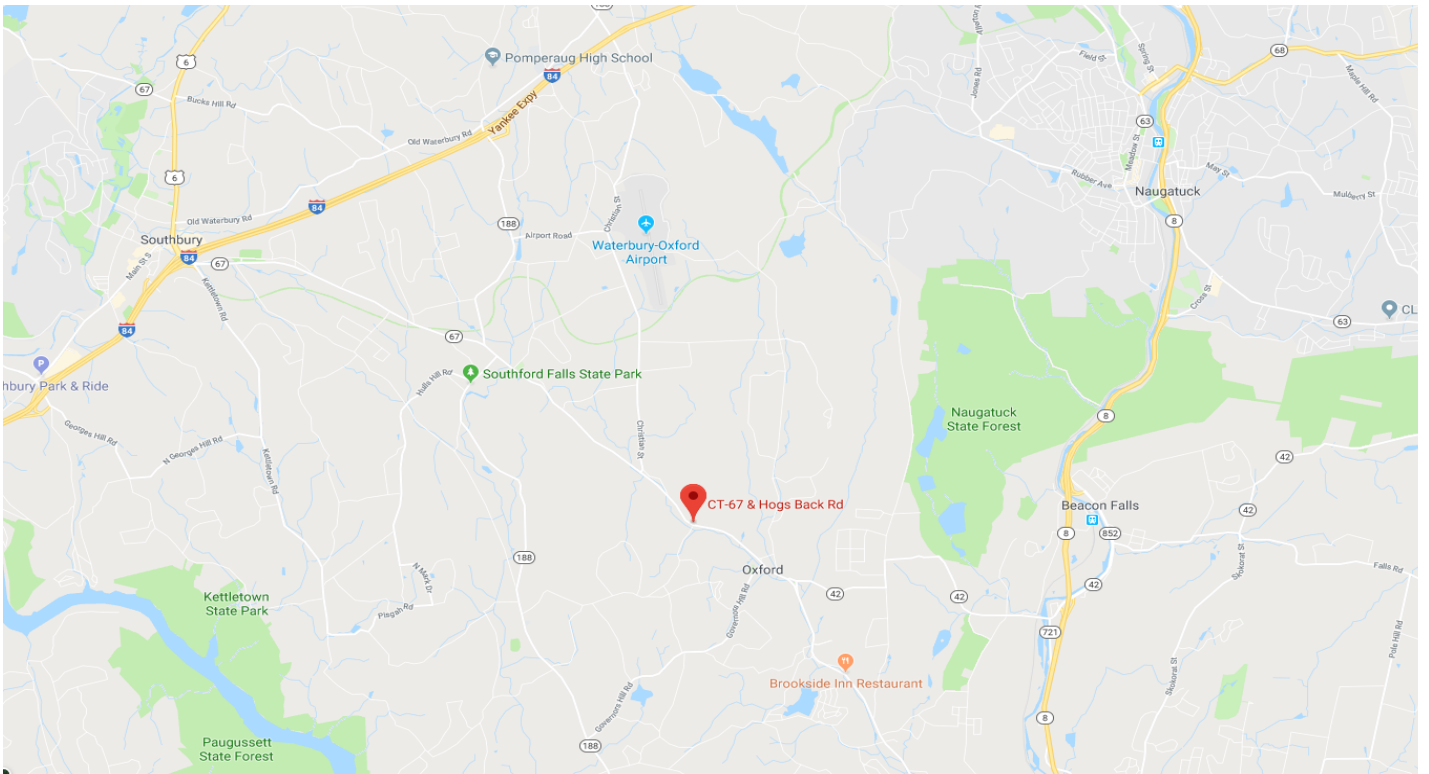

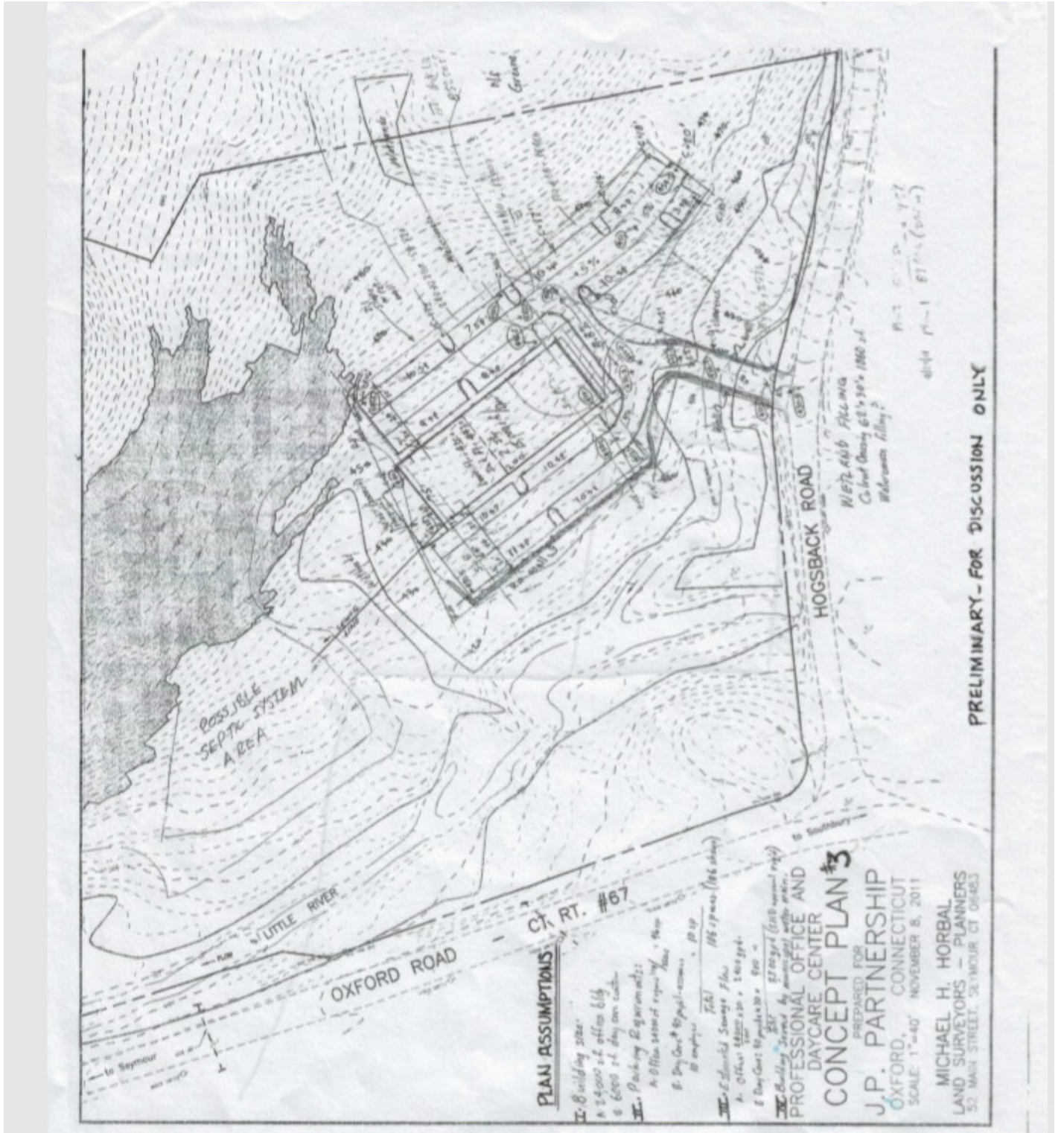

CONTACT: ED GODIN, SIOR

E-mail: EGodinPB@gmail.com

www.GodinPropertyBrokers.com

Phone: 203-577-2277 Fax: 203-577-2100

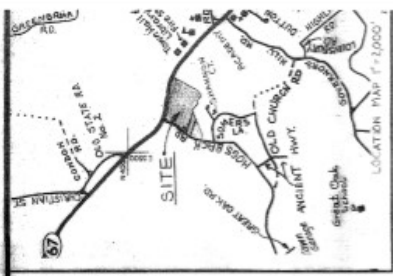

FEEL ELL NUMBER

1-1
1-2
2-1
2-2
2-3
2-4
2-5
2-6
2-7
2-8
2-9
2-10

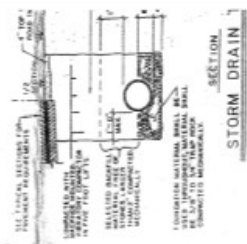

NOTE:
 ALL WORK SHALL BE DONE IN ACCORDANCE WITH THE LATEST EDITIONS OF THE CONSTRUCTION SPECIFICATIONS FOR HIGHWAY BRIDGES AND STRUCTURES, PREPARED BY THE CONNECTICUT DEPARTMENT OF TRANSPORTATION.



CULVERT CROSSING
 LOT #2
 HORIZ. - 1"=20'
 VERT. - 1"=4'

SCALE: HORIZ. - 1"=20'
 VERT. - 1"=4'

CULVERT CROSSING
 LOT #1
 HORIZ. - 1"=20'
 VERT. - 1"=4'

SCALE: HORIZ. - 1"=20'
 VERT. - 1"=4'

TOTAL AREA = 31.9774 ACRES

NO.	DATE	DESCRIPTION
1	10/15/18	PRELIMINARY
2	11/15/18	REVISED
3	12/15/18	REVISED
4	01/15/19	REVISED
5	02/15/19	REVISED
6	03/15/19	REVISED
7	04/15/19	REVISED
8	05/15/19	REVISED
9	06/15/19	REVISED
10	07/15/19	REVISED
11	08/15/19	REVISED
12	09/15/19	REVISED
13	10/15/19	REVISED
14	11/15/19	REVISED
15	12/15/19	REVISED
16	01/15/20	REVISED
17	02/15/20	REVISED
18	03/15/20	REVISED
19	04/15/20	REVISED
20	05/15/20	REVISED
21	06/15/20	REVISED
22	07/15/20	REVISED
23	08/15/20	REVISED
24	09/15/20	REVISED
25	10/15/20	REVISED
26	11/15/20	REVISED
27	12/15/20	REVISED
28	01/15/21	REVISED
29	02/15/21	REVISED
30	03/15/21	REVISED
31	04/15/21	REVISED
32	05/15/21	REVISED
33	06/15/21	REVISED
34	07/15/21	REVISED
35	08/15/21	REVISED
36	09/15/21	REVISED
37	10/15/21	REVISED
38	11/15/21	REVISED
39	12/15/21	REVISED
40	01/15/22	REVISED
41	02/15/22	REVISED
42	03/15/22	REVISED
43	04/15/22	REVISED
44	05/15/22	REVISED
45	06/15/22	REVISED
46	07/15/22	REVISED
47	08/15/22	REVISED
48	09/15/22	REVISED
49	10/15/22	REVISED
50	11/15/22	REVISED
51	12/15/22	REVISED
52	01/15/23	REVISED
53	02/15/23	REVISED
54	03/15/23	REVISED
55	04/15/23	REVISED
56	05/15/23	REVISED
57	06/15/23	REVISED
58	07/15/23	REVISED
59	08/15/23	REVISED
60	09/15/23	REVISED
61	10/15/23	REVISED
62	11/15/23	REVISED
63	12/15/23	REVISED
64	01/15/24	REVISED
65	02/15/24	REVISED
66	03/15/24	REVISED
67	04/15/24	REVISED
68	05/15/24	REVISED
69	06/15/24	REVISED
70	07/15/24	REVISED
71	08/15/24	REVISED
72	09/15/24	REVISED
73	10/15/24	REVISED
74	11/15/24	REVISED
75	12/15/24	REVISED
76	01/15/25	REVISED
77	02/15/25	REVISED
78	03/15/25	REVISED
79	04/15/25	REVISED
80	05/15/25	REVISED
81	06/15/25	REVISED
82	07/15/25	REVISED
83	08/15/25	REVISED
84	09/15/25	REVISED
85	10/15/25	REVISED
86	11/15/25	REVISED
87	12/15/25	REVISED
88	01/15/26	REVISED
89	02/15/26	REVISED
90	03/15/26	REVISED
91	04/15/26	REVISED
92	05/15/26	REVISED
93	06/15/26	REVISED
94	07/15/26	REVISED
95	08/15/26	REVISED
96	09/15/26	REVISED
97	10/15/26	REVISED
98	11/15/26	REVISED
99	12/15/26	REVISED
100	01/15/27	REVISED
101	02/15/27	REVISED
102	03/15/27	REVISED
103	04/15/27	REVISED
104	05/15/27	REVISED
105	06/15/27	REVISED
106	07/15/27	REVISED
107	08/15/27	REVISED
108	09/15/27	REVISED
109	10/15/27	REVISED
110	11/15/27	REVISED
111	12/15/27	REVISED
112	01/15/28	REVISED
113	02/15/28	REVISED
114	03/15/28	REVISED
115	04/15/28	REVISED
116	05/15/28	REVISED
117	06/15/28	REVISED
118	07/15/28	REVISED
119	08/15/28	REVISED
120	09/15/28	REVISED
121	10/15/28	REVISED
122	11/15/28	REVISED
123	12/15/28	REVISED
124	01/15/29	REVISED
125	02/15/29	REVISED
126	03/15/29	REVISED
127	04/15/29	REVISED
128	05/15/29	REVISED
129	06/15/29	REVISED
130	07/15/29	REVISED
131	08/15/29	REVISED
132	09/15/29	REVISED
133	10/15/29	REVISED
134	11/15/29	REVISED
135	12/15/29	REVISED
136	01/15/30	REVISED
137	02/15/30	REVISED
138	03/15/30	REVISED
139	04/15/30	REVISED
140	05/15/30	REVISED
141	06/15/30	REVISED
142	07/15/30	REVISED
143	08/15/30	REVISED
144	09/15/30	REVISED
145	10/15/30	REVISED
146	11/15/30	REVISED
147	12/15/30	REVISED
148	01/15/31	REVISED
149	02/15/31	REVISED
150	03/15/31	REVISED
151	04/15/31	REVISED
152	05/15/31	REVISED
153	06/15/31	REVISED
154	07/15/31	REVISED
155	08/15/31	REVISED
156	09/15/31	REVISED
157	10/15/31	REVISED
158	11/15/31	REVISED
159	12/15/31	REVISED
160	01/15/32	REVISED
161	02/15/32	REVISED
162	03/15/32	REVISED
163	04/15/32	REVISED
164	05/15/32	REVISED
165	06/15/32	REVISED
166	07/15/32	REVISED
167	08/15/32	REVISED
168	09/15/32	REVISED
169	10/15/32	REVISED
170	11/15/32	REVISED
171	12/15/32	REVISED
172	01/15/33	REVISED
173	02/15/33	REVISED
174	03/15/33	REVISED
175	04/15/33	REVISED
176	05/15/33	REVISED
177	06/15/33	REVISED
178	07/15/33	REVISED
179	08/15/33	REVISED
180	09/15/33	REVISED
181	10/15/33	REVISED
182	11/15/33	REVISED
183	12/15/33	REVISED
184	01/15/34	REVISED
185	02/15/34	REVISED
186	03/15/34	REVISED
187	04/15/34	REVISED
188	05/15/34	REVISED
189	06/15/34	REVISED
190	07/15/34	REVISED
191	08/15/34	REVISED
192	09/15/34	REVISED
193	10/15/34	REVISED
194	11/15/34	REVISED
195	12/15/34	REVISED
196	01/15/35	REVISED
197	02/15/35	REVISED
198	03/15/35	REVISED
199	04/15/35	REVISED
200	05/15/35	REVISED
201	06/15/35	REVISED
202	07/15/35	REVISED
203	08/15/35	REVISED
204	09/15/35	REVISED
205	10/15/35	REVISED
206	11/15/35	REVISED
207	12/15/35	REVISED
208	01/15/36	REVISED
209	02/15/36	REVISED
210	03/15/36	REVISED
211	04/15/36	REVISED
212	05/15/36	REVISED
213	06/15/36	REVISED
214	07/15/36	REVISED
215	08/15/36	REVISED
216	09/15/36	REVISED
217	10/15/36	REVISED
218	11/15/36	REVISED
219	12/15/36	REVISED
220	01/15/37	REVISED
221	02/15/37	REVISED
222	03/15/37	REVISED
223	04/15/37	REVISED
224	05/15/37	REVISED
225	06/15/37	REVISED
226	07/15/37	REVISED
227	08/15/37	REVISED
228	09/15/37	REVISED
229	10/15/37	REVISED
230	11/15/37	REVISED
231	12/15/37	REVISED
232	01/15/38	REVISED
233	02/15/38	REVISED
234	03/15/38	REVISED
235	04/15/38	REVISED
236	05/15/38	REVISED
237	06/15/38	REVISED
238	07/15/38	REVISED
239	08/15/38	REVISED
240	09/15/38	REVISED
241	10/15/38	REVISED
242	11/15/38	REVISED
243	12/15/38	REVISED
244	01/15/39	REVISED
245	02/15/39	REVISED
246	03/15/39	REVISED
247	04/15/39	REVISED
248	05/15/39	REVISED
249	06/15/39	REVISED
250	07/15/39	REVISED
251	08/15/39	REVISED
252	09/15/39	REVISED
253	10/15/39	REVISED
254	11/15/39	REVISED
255	12/15/39	REVISED
256	01/15/40	REVISED
257	02/15/40	REVISED
258	03/15/40	REVISED
259	04/15/40	REVISED
260	05/15/40	REVISED
261	06/15/40	REVISED
262	07/15/40	REVISED
263	08/15/40	REVISED
264	09/15/40	REVISED
265	10/15/40	REVISED
266	11/15/40	REVISED
267	12/15/40	REVISED
268	01/15/41	REVISED
269	02/15/41	REVISED
270	03/15/41	REVISED
271	04/15/41	REVISED
272	05/15/41	REVISED
273	06/15/41	REVISED
274	07/15/41	REVISED
275	08/15/41	REVISED
276	09/15/41	REVISED
277	10/15/41	REVISED
278	11/15/41	REVISED
279	12/15/41	REVISED
280	01/15/42	REVISED
281	02/15/42	REVISED
282	03/15/42	REVISED
283	04/15/42	REVISED
284	05/15/42	REVISED
285	06/15/42	REVISED
286	07/15/42	REVISED
287	08/15/42	REVISED
288	09/15/42	REVISED
289	10/15/42	REVISED
290	11/15/42	REVISED
291	12/15/42	REVISED
292	01/15/43	REVISED
293	02/15/43	REVISED
294	03/15/43	REVISED
295	04/15/43	REVISED
296	05/15/43	REVISED
297	06/15/43	REVISED
298	07/15/43	REVISED
299	08/15/43	REVISED
300	09/15/43	REVISED
301	10/15/43	REVISED
302	11/15/43	REVISED
303	12/15/43	REVISED
304	01/15/44	REVISED
305	02/15/44	REVISED

