



CONTACT: BRIAN GODIN
E-mail: Bgodinpb@gmail.com
www.GodinPropertyBrokers.com
Phone: 203-577-2277 Fax: 203-577-2100
850 Straits Turnpike, Suite 204
Middlebury, CT, 06762

FOR LEASE

*76 Watertown Rd
Thomaston, CT 06787*



Thomaston's Vibrant New Power Center
Retail / Professional Office Space
2 Suites Available from 1,500 S/F
Ideal for retail, office and business professionals
Located right off Route 8 and Exit 38
Lease Rate: \$14.00 to \$16.00 PSF Gross

All information furnished is from sources deemed reliable and is submitted subject to errors, omissions, change of other terms of conditions, prior sale, lease or financing or withdrawal-all without notice. No representation is made or implied by Godin Property Brokers, LLC or its associates as to the accuracy of the information submitted herein.

PROPERTY DATA FORM

PROPERTY ADDRESS	76 Watertown Road
CITY, STATE	Thomaston, CT 06787

BUILDING INFO		MECHANICAL EQUIP.	
Total S/F	36,678 +/-	Air Conditioning	Central
Number of Floors	2	Sprinkler / Type	Yes
Avail. S/F	9,000 +/-	Type of Heat	Gas/ Eclectic
Will Subdivide To...	750	TAXES	
Avail. Docks		Assessment	
Ext. Construction	Block	Mill Rate	
Int. Construction		Taxes	TBD
Ceiling Height	8' - 16'	OTHER	
Roof	New	Total Acres	8 +/-
Date Built	2015	Zoning	Commercial
UTILITIES		Parking	Ample
Sewer	City	State Route / Distance To...	Route 8 / Exit 38
Water	City	TERMS	
Gas	Yes	Lease Rate	\$12- \$16 PSF Gross
Electrical	200 amps		

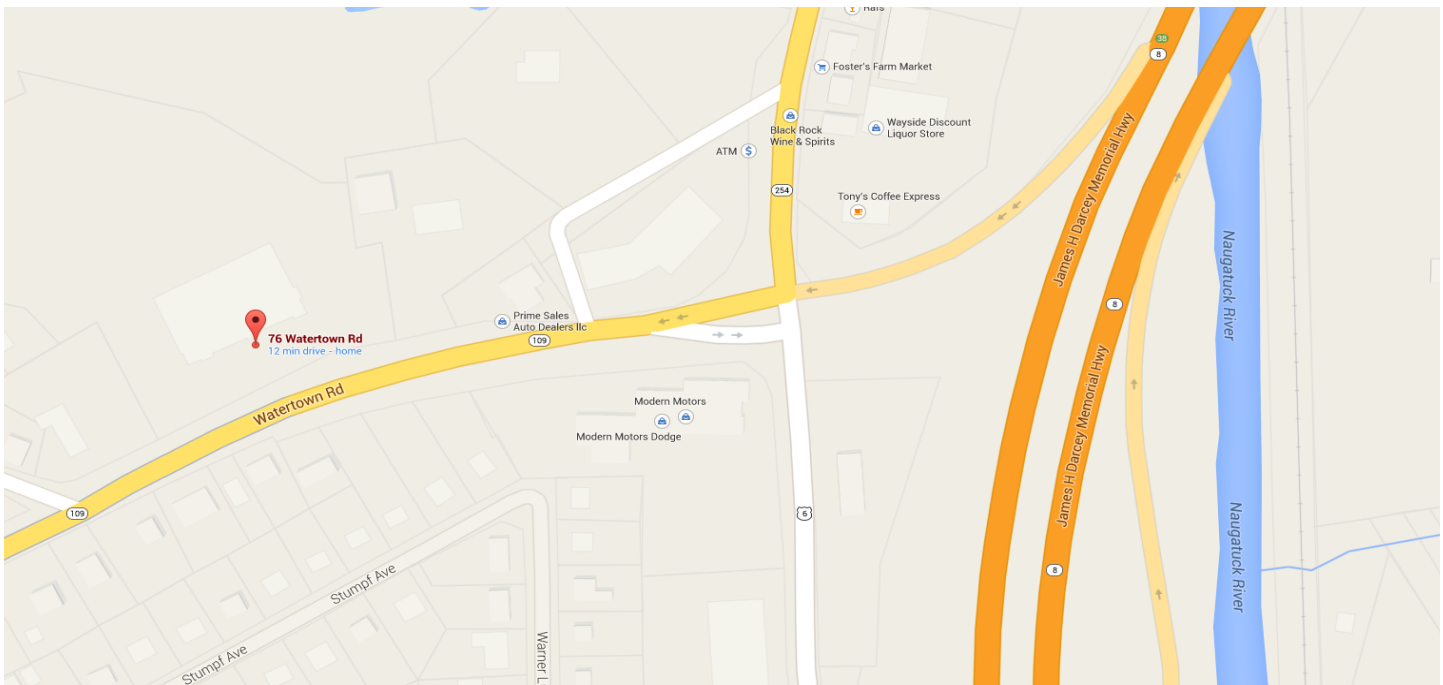



Original Building



Newly designed 2015



Unexcavated

Unexcavated

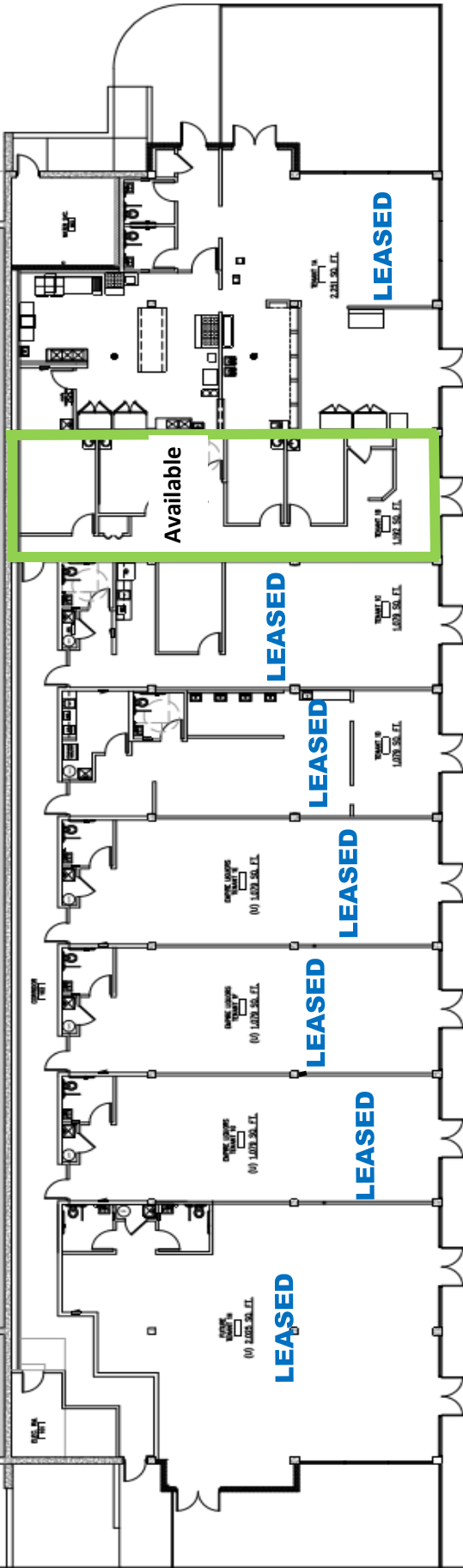

DATE	10/11/15
SCALE	1/8"=1'-0"
DRAWN	DC
CND	DK
APPD	DK



First Floor Tenant Spaces

DLM Professional Plaza
76 Watertown Road
Thomaston, Connecticut

A1

