

**FOR SALE**



***Corner of Oxford Rd  
(RTE 67) & Hogs Back Rd  
Oxford, CT 06478***

**26 Acres**  
**Oxford Professional District Zoned Land**  
**High traffic corner location on RTE 67**  
**Traffic Count 12,000 Cars**  
**Daily per DOT**  
**Many Development Options**  
**Low Price of: \$239,000.00**



All information furnished is from sources deemed reliable and is submitted subject to errors, omissions, change of other terms of conditions, prior sale, lease or financing or withdrawal-all without notice. No representation is made or implied by Godin Property Brokers, LLC or its associates as to the accuracy of the information submitted herein.

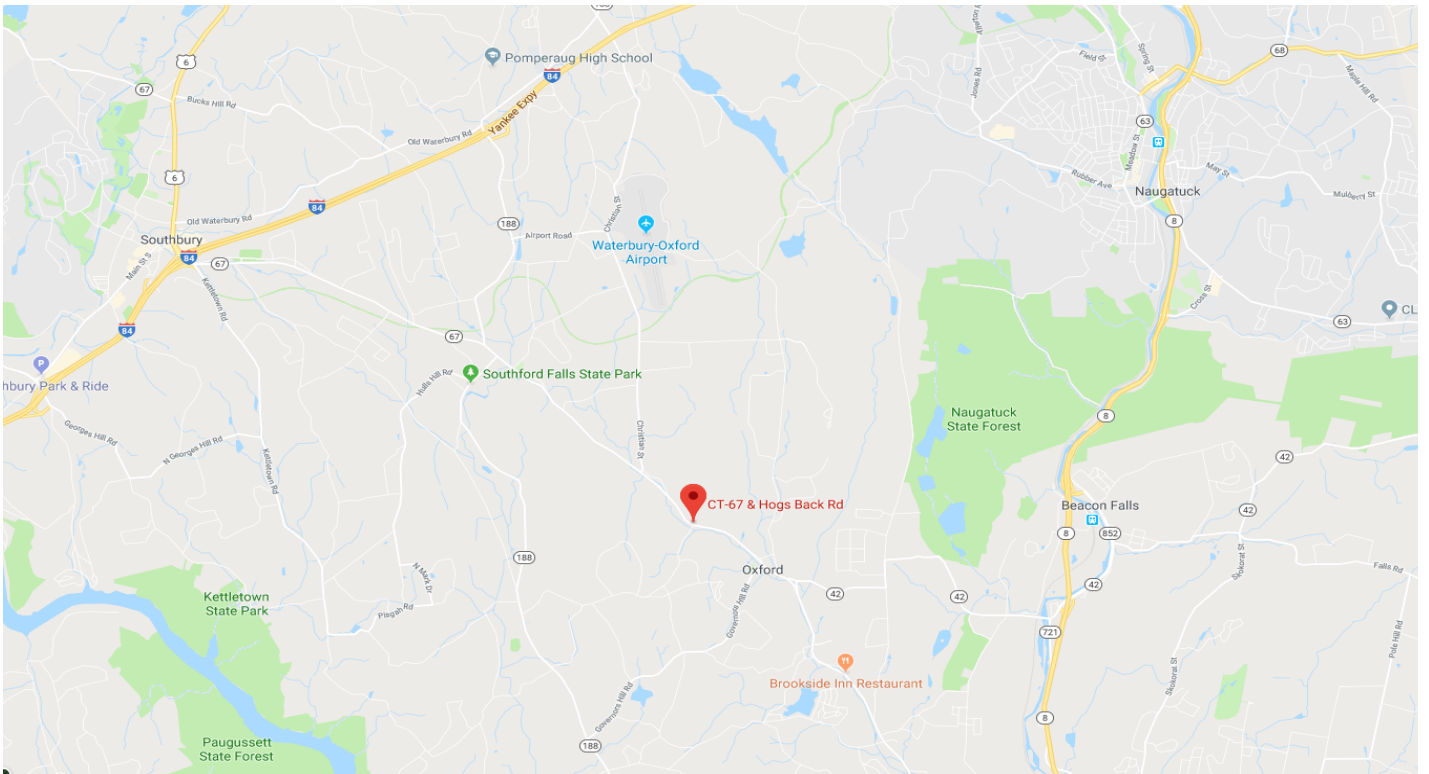

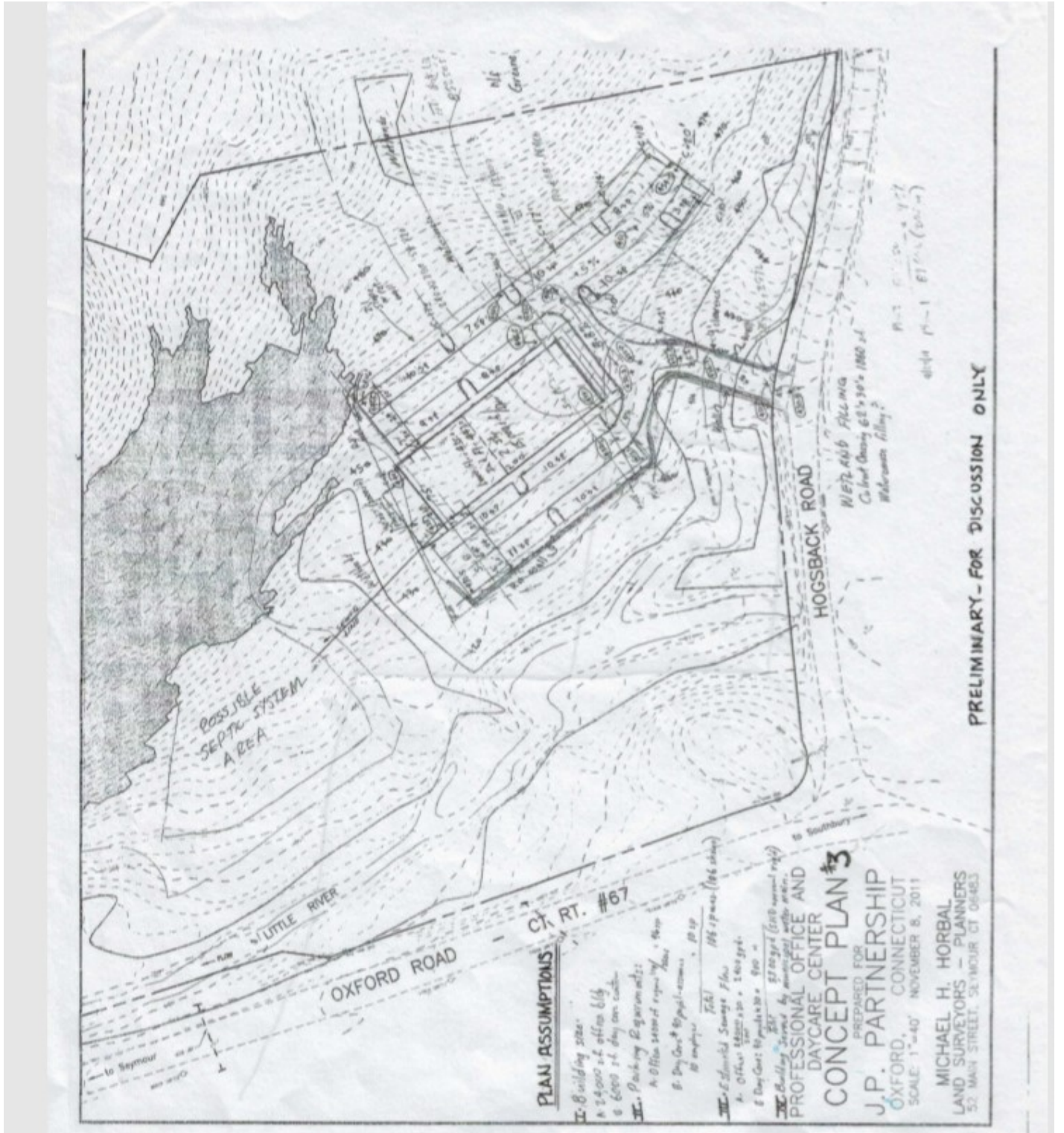

**CONTACT: ED GODIN, SIOR**

E-mail: [EGodinPB@gmail.com](mailto:EGodinPB@gmail.com)

[www.GodinPropertyBrokers.com](http://www.GodinPropertyBrokers.com)

Phone: 203-577-2277 Fax: 203-577-2100

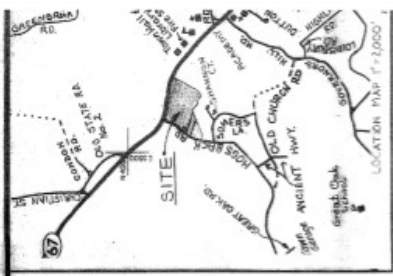

FEEL ELL NUMBER

1-1
1-2
2-1
2-2
2-3
2-4
2-5
2-6
2-7
2-8
2-9
2-10

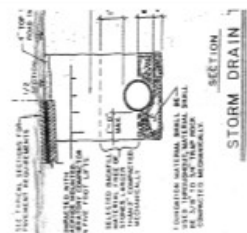

NOTE:  
 ALL WORK SHALL BE DONE IN ACCORDANCE WITH THE LATEST EDITIONS OF THE CONSTRUCTION SPECIFICATIONS FOR HIGHWAY BRIDGE AND STRUCTURES, PREPARED BY THE CONNECTICUT DEPARTMENT OF TRANSPORTATION.

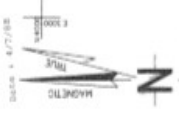

NOTE: SEE SHEET 1-2, CONTINUED FOR ELEVATIONS AND EXPOSURES OF EACH BRIDGE CROSSING.

NOTE: SEE SHEET 1-2, CONTINUED FOR ELEVATIONS AND EXPOSURES OF EACH BRIDGE CROSSING.

CLASS 'X' CONCRETE

DIMENSIONS AND QUANTITIES FOR BRIDGE TYPE

NO.	DESCRIPTION	QTY.	UNIT	QTY.	UNIT	QTY.	UNIT	QTY.	UNIT
1	CONCRETE	1.00	CU YD	1.00	CU YD	1.00	CU YD	1.00	CU YD
2	GRAVEL	1.00	CU YD	1.00	CU YD	1.00	CU YD	1.00	CU YD
3	STEEL	1.00	LB	1.00	LB	1.00	LB	1.00	LB
4	WOOD	1.00	CU YD	1.00	CU YD	1.00	CU YD	1.00	CU YD
5	BRICK	1.00	CU YD	1.00	CU YD	1.00	CU YD	1.00	CU YD
6	CEMENT	1.00	CU YD	1.00	CU YD	1.00	CU YD	1.00	CU YD
7	IRON	1.00	LB	1.00	LB	1.00	LB	1.00	LB
8	STEEL	1.00	LB	1.00	LB	1.00	LB	1.00	LB
9	WOOD	1.00	CU YD	1.00	CU YD	1.00	CU YD	1.00	CU YD
10	BRICK	1.00	CU YD	1.00	CU YD	1.00	CU YD	1.00	CU YD
11	CEMENT	1.00	CU YD	1.00	CU YD	1.00	CU YD	1.00	CU YD
12	IRON	1.00	LB	1.00	LB	1.00	LB	1.00	LB
13	STEEL	1.00	LB	1.00	LB	1.00	LB	1.00	LB
14	WOOD	1.00	CU YD	1.00	CU YD	1.00	CU YD	1.00	CU YD
15	BRICK	1.00	CU YD	1.00	CU YD	1.00	CU YD	1.00	CU YD
16	CEMENT	1.00	CU YD	1.00	CU YD	1.00	CU YD	1.00	CU YD
17	IRON	1.00	LB	1.00	LB	1.00	LB	1.00	LB
18	STEEL	1.00	LB	1.00	LB	1.00	LB	1.00	LB
19	WOOD	1.00	CU YD	1.00	CU YD	1.00	CU YD	1.00	CU YD
20	BRICK	1.00	CU YD	1.00	CU YD	1.00	CU YD	1.00	CU YD
21	CEMENT	1.00	CU YD	1.00	CU YD	1.00	CU YD	1.00	CU YD
22	IRON	1.00	LB	1.00	LB	1.00	LB	1.00	LB
23	STEEL	1.00	LB	1.00	LB	1.00	LB	1.00	LB
24	WOOD	1.00	CU YD	1.00	CU YD	1.00	CU YD	1.00	CU YD
25	BRICK	1.00	CU YD	1.00	CU YD	1.00	CU YD	1.00	CU YD
26	CEMENT	1.00	CU YD	1.00	CU YD	1.00	CU YD	1.00	CU YD
27	IRON	1.00	LB	1.00	LB	1.00	LB	1.00	LB
28	STEEL	1.00	LB	1.00	LB	1.00	LB	1.00	LB
29	WOOD	1.00	CU YD	1.00	CU YD	1.00	CU YD	1.00	CU YD
30	BRICK	1.00	CU YD	1.00	CU YD	1.00	CU YD	1.00	CU YD
31	CEMENT	1.00	CU YD	1.00	CU YD	1.00	CU YD	1.00	CU YD
32	IRON	1.00	LB	1.00	LB	1.00	LB	1.00	LB
33	STEEL	1.00	LB	1.00	LB	1.00	LB	1.00	LB
34	WOOD	1.00	CU YD	1.00	CU YD	1.00	CU YD	1.00	CU YD
35	BRICK	1.00	CU YD	1.00	CU YD	1.00	CU YD	1.00	CU YD
36	CEMENT	1.00	CU YD	1.00	CU YD	1.00	CU YD	1.00	CU YD
37	IRON	1.00	LB	1.00	LB	1.00	LB	1.00	LB
38	STEEL	1.00	LB	1.00	LB	1.00	LB	1.00	LB
39	WOOD	1.00	CU YD	1.00	CU YD	1.00	CU YD	1.00	CU YD
40	BRICK	1.00	CU YD	1.00	CU YD	1.00	CU YD	1.00	CU YD
41	CEMENT	1.00	CU YD	1.00	CU YD	1.00	CU YD	1.00	CU YD
42	IRON	1.00	LB	1.00	LB	1.00	LB	1.00	LB
43	STEEL	1.00	LB	1.00	LB	1.00	LB	1.00	LB
44	WOOD	1.00	CU YD	1.00	CU YD	1.00	CU YD	1.00	CU YD
45	BRICK	1.00	CU YD	1.00	CU YD	1.00	CU YD	1.00	CU YD
46	CEMENT	1.00	CU YD	1.00	CU YD	1.00	CU YD	1.00	CU YD
47	IRON	1.00	LB	1.00	LB	1.00	LB	1.00	LB
48	STEEL	1.00	LB	1.00	LB	1.00	LB	1.00	LB
49	WOOD	1.00	CU YD	1.00	CU YD	1.00	CU YD	1.00	CU YD
50	BRICK	1.00	CU YD	1.00	CU YD	1.00	CU YD	1.00	CU YD



CULVERT CROSSING  
 LOT # 2  
 HORIZ. - 1"=20'  
 VERT. - 1"=4'

CULVERT CROSSING  
 LOT # 1  
 HORIZ. - 1"=20'  
 VERT. - 1"=4'

DATE: \_\_\_\_\_  
 DRAWN BY: \_\_\_\_\_  
 CHECKED BY: \_\_\_\_\_  
 APPROVED BY: \_\_\_\_\_  
 TITLE: \_\_\_\_\_

**J. P. PARTNERSHI**  
**SUBDIVISION**  
 OXFORD, CONNECTICUT  
 MICHAEL H. HORBAL - LAND SURVEYOR - EXHIBIT  
 450 Main Street - Seymour, Connecticut

TOTAL AREA = 31.9774 ACRES

NOTES

