

FOR LEASE



**9 Britton Drive
Bloomfield, CT 06002**

**8,200 +/- S/F Industrial Space
2020 Remodel - New Lights, Bath, & Paint
Sub-dividable to 4,100 S/F
13' Ceilings with Oversized Drive in Door
Mid State Location with Easy I-91 Access
Lease Asking: \$10 - \$12 PSF Gross + Utilities**



PROPERTY DATA FORM

PROPERTY ADDRESS	9 Britton Drive
CITY, STATE	Bloomfield, CT 06002

BUILDING INFO		MECHANICAL EQUIP.	
Total S/F	22,710 +/-	Air Conditioning	No
Number of floors	1	Sprinkler / Type	Yes
Avail S/F	8,200 +/-	Type of Heat	Gas F/A
Will subdivide to	4,100 +/-	OTHER	
Ceiling Height	13'	Acres	3.44
Roof	Insulated Rubber	Zoning	I2
Ext. Construction	Brick	Parking	Ample
Date Built	1967	State Route / Distance To...	Route 8/
Total avail/ drive-in	1	TAXES	
Loading Dock	1	Assessment	
UTILITIES		Appraisal	
	Tenant/Buyer to Verify	Mill Rate	
Sewer	City	Taxes	
Water	City	TERMS	
Gas	CNG	Lease	\$10 - \$12 PSF Gross + Utilities
Electrical	200 Amp		

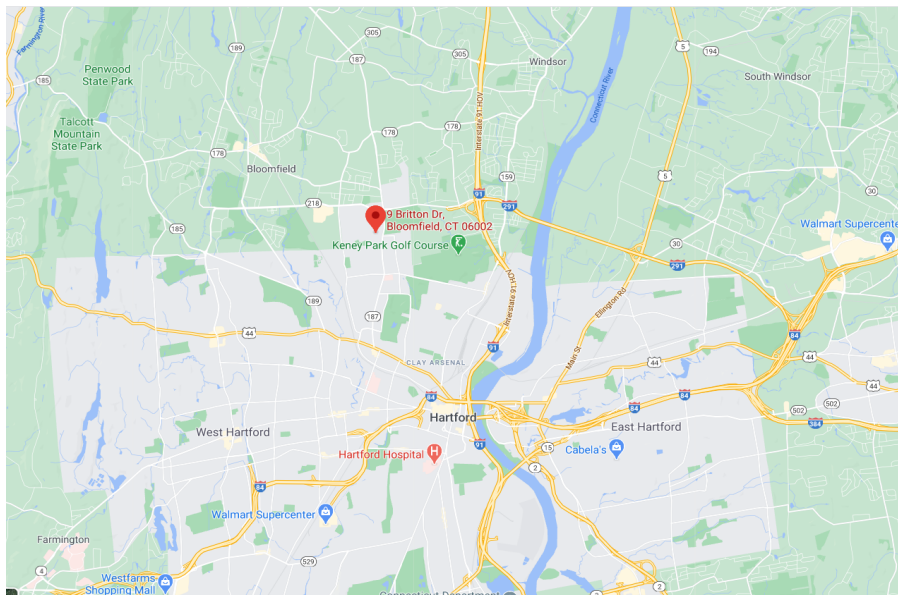

CONTACT: BRIAN GODIN
 E-mail: BgodinPB@gmail.com
 www.GodinPropertyBrokers.com

All information furnished is from sources deemed reliable and is submitted subject to errors, omissions, change of other terms of conditions, prior sale, lease or financing or withdrawal-all without notice. No representation is made or implied by Godin Property Brokers, LLC or its associates as to the accuracy of the information submitted herein.



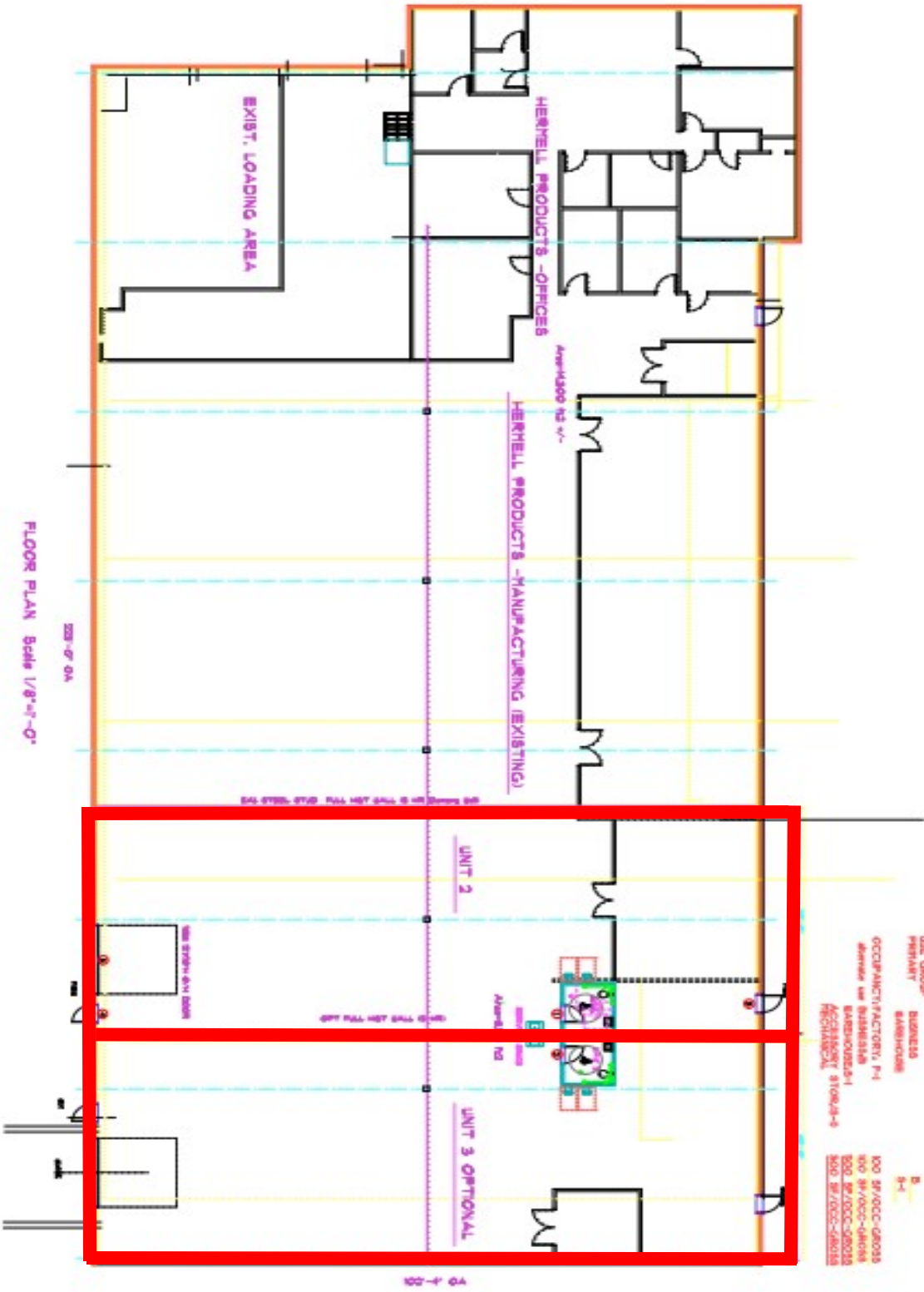

CODE INFORMATION

TYPE CONSTRUCTION
C FIRE SUPPRESSION (level)

TYPE SB (ceiling)

USE GROUP
 PRIMARY BUSINESS
 MANUFACTURE
 OCCUPANCY FACTORY, F-1
 ASSEMBLY SEE BUSINESS
 LABORATORY
 ACCESSORY STORAGE-9
 MECHANICAL

1-1
 100 SF/OCC-06035
 500 SF/OCC-04034
 500 SF/OCC-28035
 800 SF/OCC-08035

PLAN LAYOUT

MEDLAND BUILDING ALTERATIONS/SUBDIVISION
 9 BRITTEN AVENUE
 BLOOMFIELD, CONNECTICUT

PROJECT:

JOSEPH S. ALICATA ARCHITECT

104 BROOK ROAD | TEL: (860) 353-0422
 PO BOX 501 | JOA@alicates.com
 C. HARTLAND, CT 06037 | (860) 353-0422

SCALE:
 ARCHITECTURAL
 GENERAL NOTES
 PROJECT NO. 1023
 DATE: JULY 2008

A.01