

## ***Ready For Occupancy***



***1215 - 1261 Meriden Rd  
Wolcott, CT 06716***  
Located on Waterbury - Wolcott Line

**New Retail / Office/ Flex Building  
Join Dollar General  
4,337 S/F Remaining  
Divisible to 1,850 S/F  
Quick Access to I-84 Near Exit 25 A  
Offered at: \$14.00 PSF NNN**



# PROPERTY DATA FORM

|                         |                  |                                 |                   |
|-------------------------|------------------|---------------------------------|-------------------|
| <b>PROPERTY ADDRESS</b> |                  | <b>1215 - 1261 Meriden Road</b> |                   |
| <b>CITY, STATE</b>      |                  | <b>Wolcott, CT 06716</b>        |                   |
| <b>BUILDING INFO</b>    |                  | <b>MECHANICAL EQUIP.</b>        |                   |
| Total S/F               | 16,632           | Air Conditioning                | Central           |
| Avail S/F               | 4,337            | Sprinkler / Type                | No                |
| Divisible               | 1,850            | Type of Heat                    | Gas               |
| Number of floors        | 1                | <b>OTHER</b>                    |                   |
| Ext. Construction       | Masonry - Steel  | Acres                           | +20               |
| Ceiling Height          | 16'              | Zoning                          | Comm./ Industrial |
| Roof                    | Steel            | Parking                         | Ample             |
| Date Built              | 2019             | State Route / Distance To...    | I-84 / 2 miles    |
|                         |                  | <b>SPACE INCLUDES:</b>          |                   |
| <b>UTILITIES</b>        | TENANT TO VERIFY | Heat & Air conditioning         |                   |
| Sewer                   | City             | Handicap bathroom               |                   |
| Water                   | City             | Drywall taped & ready for paint |                   |
| Gas                     | EverSource       |                                 |                   |
| Electrical per unit     | 200 Amps         | <b>TERMS</b>                    |                   |
|                         | 208 V/ 3 Ph.     | Lease Rate                      | \$14 PSF NNN      |



**CONTACT: MARY BUCKLEY or ED GODIN, SIOR**

E-mail: Mbuckley.gpb@gmail.com ,EgodinPB@gmail.com

www.GodinPropertyBrokers.com

Phone: 203-577-2277 Fax: 203-577-2100

All information furnished is from sources deemed reliable and is submitted subject to errors, omissions, change of other terms of conditions, prior sale, lease or financing or withdrawal-all without notice. No representation is made or implied by Godin Property Brokers, LLC or its associates as to the accuracy of the information submitted herein.

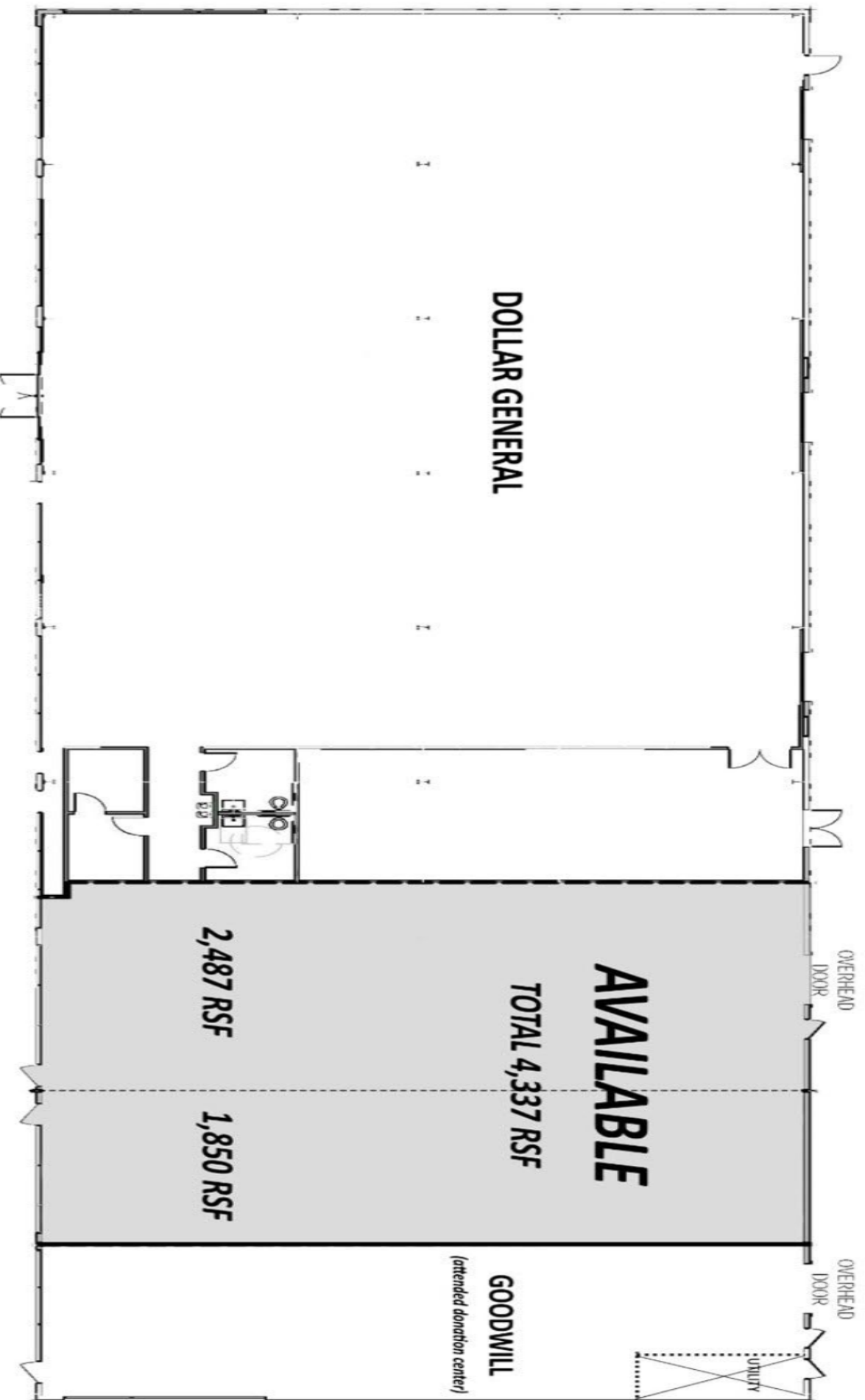





**CONTACT: MARY BUCKLEY or ED GODIN, SIOR**

E-mail: [Mbuckley.gpb@gmail.com](mailto:Mbuckley.gpb@gmail.com), [EgodinPB@gmail.com](mailto:EgodinPB@gmail.com),  
[www.GodinPropertyBrokers.com](http://www.GodinPropertyBrokers.com)

Phone: 203-577-2277 Fax: 203-577-2100



# Godin Property Brokers, LLC

★★★★★ Commercial / Industrial

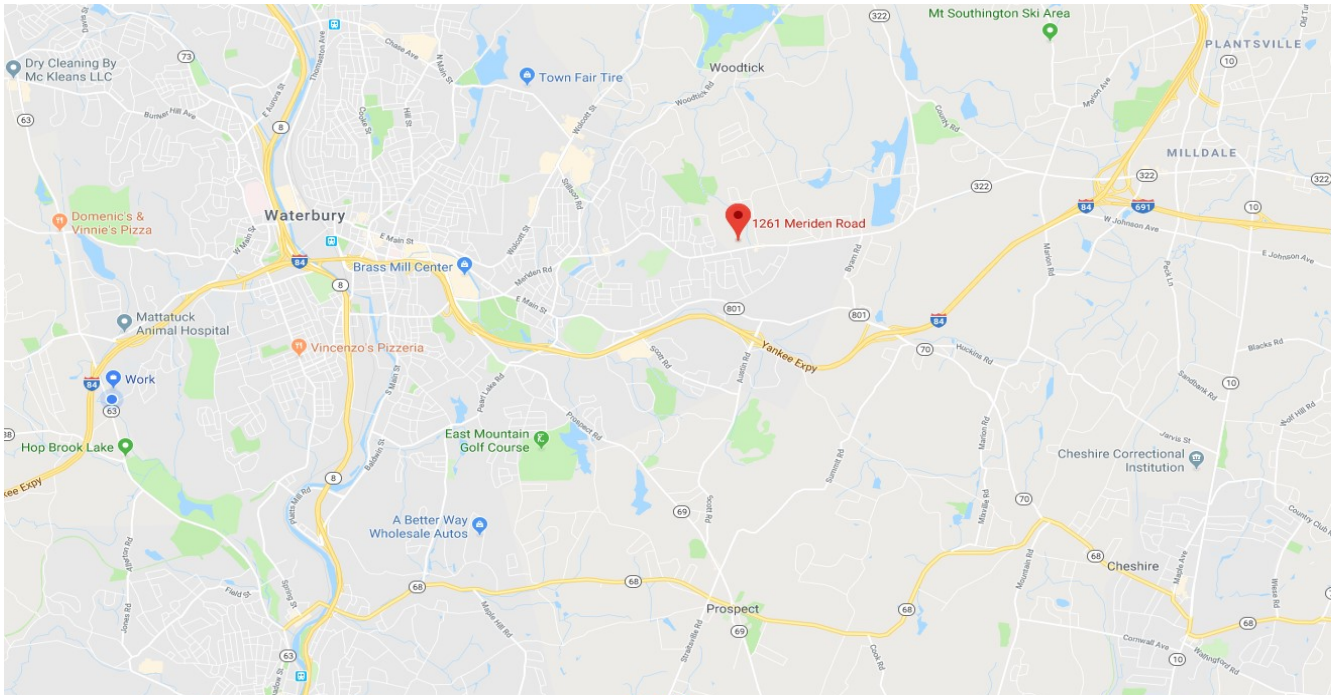
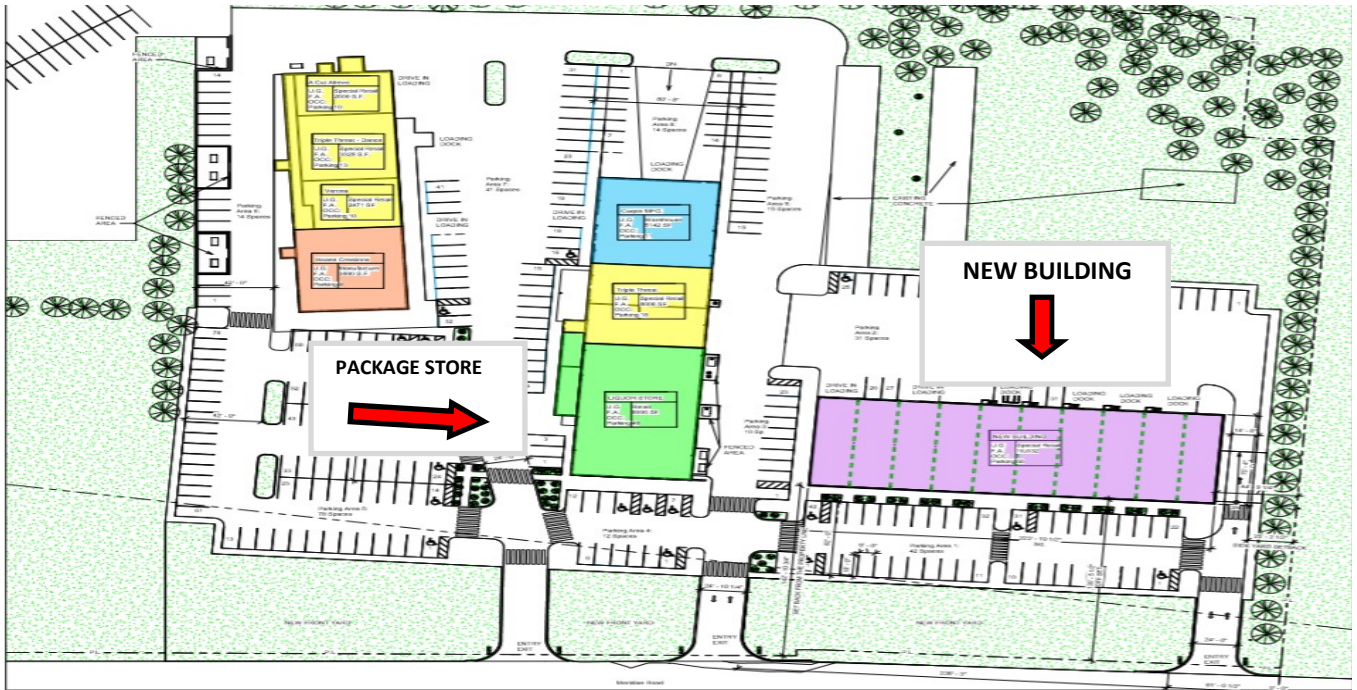

**CONTACT: MARY BUCKLEY or ED GODIN, SIOR**

E-mail: [Mbuckley.gpb@gmail.com](mailto:Mbuckley.gpb@gmail.com), [EGodinPB@gmail.com](mailto:EGodinPB@gmail.com),  
[www.GodinPropertyBrokers.com](http://www.GodinPropertyBrokers.com)

Phone: 203-577-2277 Fax: 203-577-2100