

CONTACT: MICHAEL GRIEDER  
E-mail: Mgrieder.gpb@gmail.com  
850 Straits Turnpike Suite 204  
Middlebury, CT 06762  
www.GodinPropertyBrokers.com  
Phone: 203-577-2277 Fax: 203-577-2100

# FOR LEASE



44 Waterbury Rd  
Prospect, CT 06712

1,375 +/- S/F  
Great Central Town Location  
2nd Floor Office Space Perfect for  
Most Professional Uses  
Open Floor Plan with Two Separate Offices  
And En Suite Bathroom  
Economically Priced at  
\$725.00 Modified Gross + Utilities

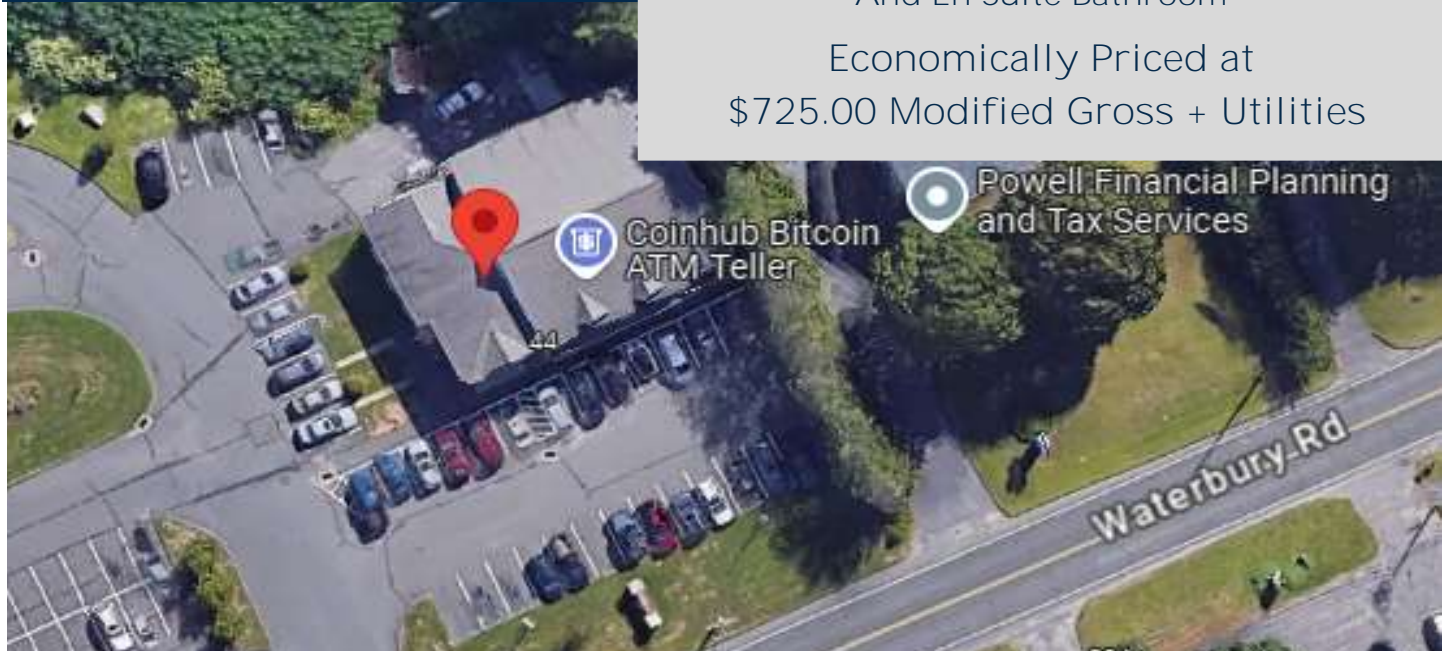

All information furnished is from sources deemed reliable and is submitted subject to errors, omissions, change of other terms of conditions, prior sale, lease or financing or withdrawal-all without notice. No representation is made or implied by Godin Property Brokers, LLC or its associates as to the accuracy of the information submitted herein.

# PROPERTY DATA FORM

PROPERTY ADDRESS	44 Waterbury Rd
CITY, STATE	Prospect, CT 06712

BUILDING INFO		MECHANICAL EQUIP.	
Total S/F	10,266 +/-	Air Conditioning	Central
Number of floors	2	Sprinkler / Type	
Avail S/F	1,375 +/-	Type of Heat	Forced Hot Air
		<b>OTHER</b>	
		Acres	1.94
		Zoning	B- Retail
		Parking	Plenty on Site
		<b>TAXES</b>	
Roof	Asphalt / Shingle	Assessment	
Ext. Construction	Vertical Wood/Concrete Block	Appraisal	
Ceiling Height	9'	Mill Rate	
Date Built	1958	Taxes	
<b>UTILITIES</b>	Buyer/Tenant to Verify	<b>TERMS</b>	
Sewer	Septic	Lease	\$725 Mod Gross + Utilities
Water	City		(% of Snow Plow)
Gas	Propane		
Electrical			



All information furnished is from sources deemed reliable and is submitted subject to errors, omissions, change of other terms of conditions, prior sale, lease or financing or withdrawal-all without notice. No representation is made or implied by Godin Property Brokers, LLC or its associates as to the accuracy of the information submitted herein.



