

# FOR LEASE



**353 Christian Street 9,10 & 11B  
Oxford, CT 06478**

**8,633 S/F Office/Warehouse**

**1,800 S/F finished office area**

**2 Loading Docks/1 Drive-in door**

**Modern Multi - Tenant Facility on 4.2 acres**

**Full A/C Heavy Power (400 amps/480 volts)**

**1 Mile to I-84 - Ample Parking**

**Airport Enterprise Zone**

**Lease asking: \$9.50 PSF NNN**

# PROPERTY DATA FORM

<b>PROPERTY ADDRESS</b>		353 Christian St 9,10 & 11	
<b>CITY, STATE</b>		Oxford, CT 06478	
<b>BUILDING INFO</b>		<b>MECHANICAL EQUIP.</b>	
Total S/F	45,000	Air Conditioning	Yes / office
Number of floors	1	Sprinkler / Type	No
Avail S/F	8,633	Type of Heat	Oil
Office Space	1,800	<b>OTHER</b>	
Available docks	2	Acres	4.2
Available drive-in-doors	1	Zoning	Industrial
Ext. Construction	Block & Steel	Parking	90 vehicles
Ceiling Height	16'	State Route / Distance To...	I84 1 mile Route 8 5 miles
Roof	Steel	<b>TAXES</b>	
Date Built	2000	Assessment	
<b>UTILITIES</b>	<b>Tenant/Buyer to Verify</b>	Mill Rate	
Sewer	City	Taxes	
Water	City	<b>TERMS</b>	
Gas	No	Lease rate	\$9.50 NNN
Electrical	400 Amps /480 volts 3 phase	Current NNN	TBD



All information furnished is from sources deemed reliable and is submitted subject to errors, omissions, change of other terms of conditions, prior sale, lease or financing or withdrawal-all without notice. No representation is made or implied by Godin Property Brokers, LLC or its associates as to the accuracy of the information submitted herein.

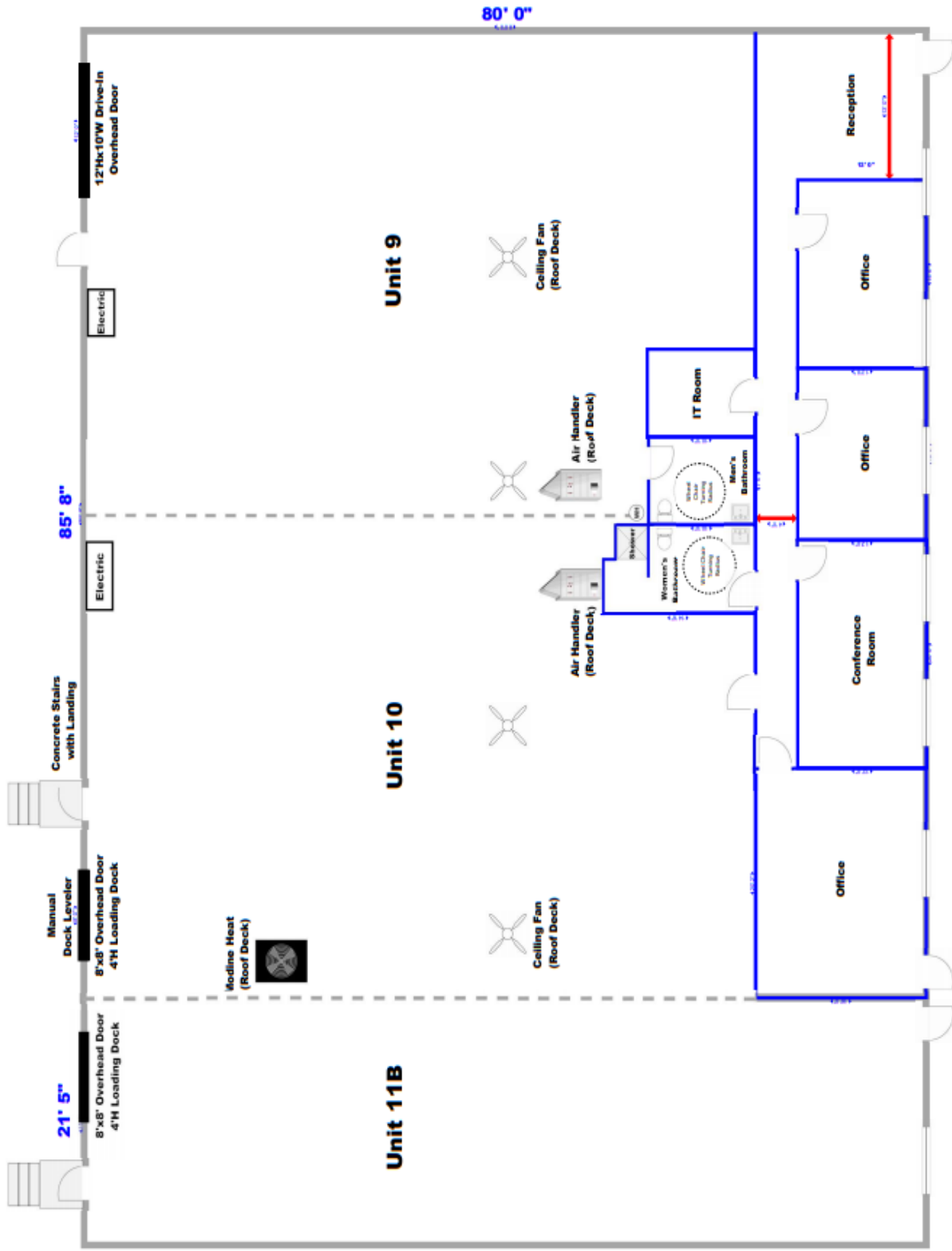

**Units 9, 10, 11B**  
**353 Christian St.**  
**Oxford, CT**  
**8,633 sf ±**

